

Uni-block system for low and medium temperature refrigeration

SB

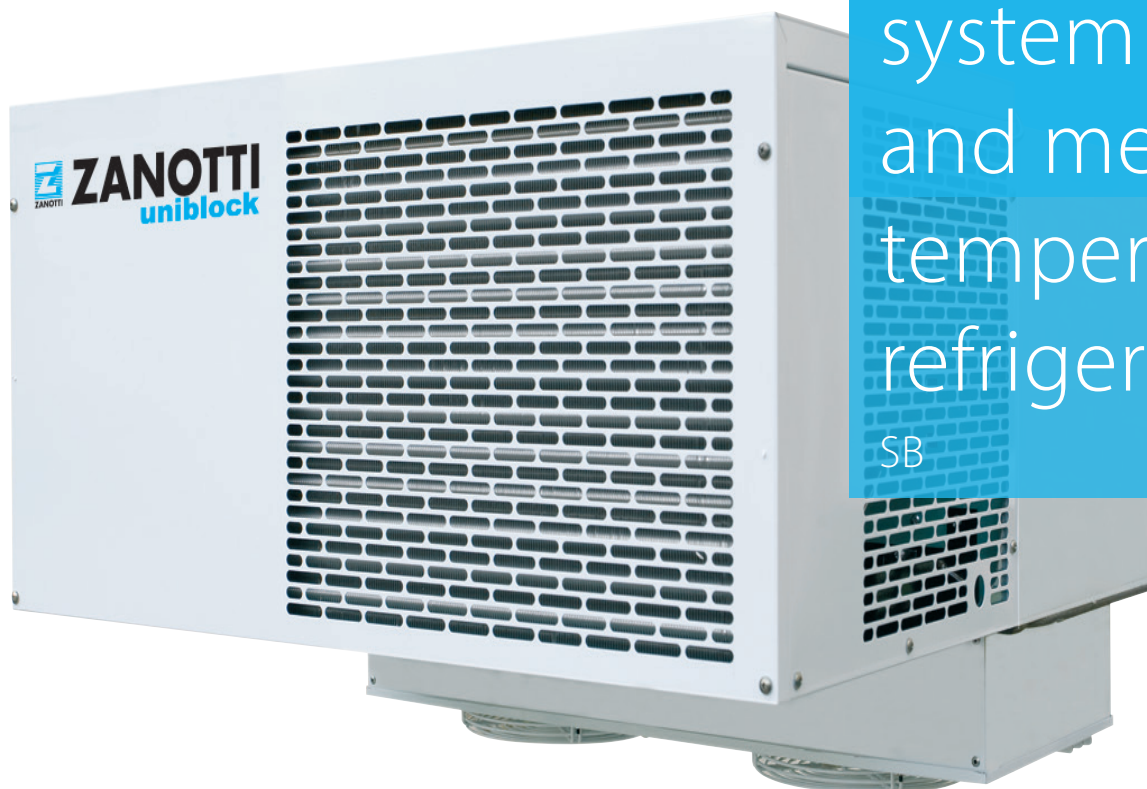

Reciprocating
compressor

For roof mounted installation in small and medium sized cold rooms

- › Rapid mounting on the roof of the cold room
- › Ceiling assembly leaves the space inside the cold room completely free
- › The white colour of the evaporator blends unobtrusively with the cold room walls
- › Extremely fast to assemble, reducing installation time and cost
- › Best surface-to-capacity ratio
- › Remote electronic command station

Installation type

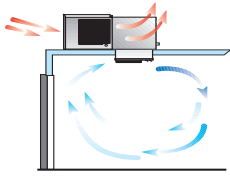

Low Temperature Refrigeration				BSB	010DA11XX	0870Y1AA	117DA11XX	220DB11XX	1710Y2AA	330DB11XX	2650Y3AC
Refrigerating capacity	Low temperature (1)	R-290	Nom	kW	-	0.873	-	-	1.713	-	2.653
		R-452A	Nom	kW	0.628	-	1.029	1.699	-	2.472	-
Dimensions	Unit	HeightxWidthxDepth		mm	525x430x771	506x620x719		540x820x809	503x1,075x924	645x820x929	762x1,300x1,044
Weight	Unit			kg	48	68		87	102		200
Compressor	Type	Hermetic Reciprocating									
	Nominal power			kW	0.6	0.9	1.3	1.5	1.8	2.2	2.7
	Starting method	Direct									
Condenser	Air flow			m ³ /h	400	750		1,400		1,500	2,000
Defrost	Hot gas										
Evaporator	Air flow			m ³ /h	500	550		1,100		2,300	2,500
	Air throw (3)			m	3			4		10	4
Operation range	Cold room Min.~Max.			°C	-25~-15						
Refrigerant	Type/GWP				R-452A/2,141.0	R-290/3	R-452A/2,141.0		R-290/3	R-452A/2,141.0	R-290/3
	Charge			kg/TCO ₂ Eq	0.50/1.07	-/-	0.42/0.90	0.72/1.54	-/-	0.96/2.06	-/-
Power supply	Phase/Frequency/Voltage			Hz/V	1~/50/230			3N~/50/400	1~/50/230	3N~/50/400	
Medium Temperature Refrigeration				MSB	005EA11XX	106EA11XX	1310Y1AA	107EA11XX	210EA11XX	212EB11XX	2180Y1AA
Refrigerating capacity	Medium temperature (2)	R-134a	Nom	kW	0.857	1.120	-	1.338	1.799	2.022	-
		R-290	Nom	kW	-	-	1.309	-	-	-	2.179
Dimensions	Unit	HeightxWidthxDepth		mm	525x430x771	506x620x719			540x820x809		
Weight	Unit			kg	42	59			74	75	
Compressor	Type	Hermetic Reciprocating									
	Nominal power			kW	0.5	0.6	0.56	0.7	0.9	1.7	0.9
	Starting method	Direct									
Condenser	Air flow			m ³ /h	400	750			1,400		
Defrost	Hot gas										
Evaporator	Air flow			m ³ /h	500	550			1,100		
	Air throw (3)			m	3				4		
Operation range	Cold room Min.~Max.			°C	-5~-10						
Refrigerant	Type/GWP				R-134a/1,430.0		R-290/3	R-134a/1,430.0			R-290/3
	Charge			kg/TCO ₂ Eq	0.47/0.67	0.40/0.57	-/-	0.46/0.66	0.75/1.07	0.78/1.12	-/-
Power supply	Phase/Frequency/Voltage			Hz/V	1~/50/230					3N~/50/400	1~/50/230
Medium Temperature Refrigeration				MSB	315EB11XX	3370Y2AA	320EB11XX	425EB11XX	530EB11XX	5820Y3AB	
Refrigerating capacity	Medium temperature (2)	R-134a	Nom	kW	3.282	-	3.550		3.774	4.871	-
		R-290	Nom	kW	-	3.367		-		-	5.821
Dimensions	Unit	HeightxWidthxDepth		mm	645x820x929	652x1,300x1,044	645x820x929	760x920x1,042	785x1,075x1,046	652x1,300x1,044	
Weight	Unit			kg	92	75	92	110	151	75	
Compressor	Type	Hermetic Reciprocating									
	Nominal power			kW	2.2	1.12	2.6	2.9	3.7	2.7	
	Starting method	Direct									
Condenser	Air flow			m ³ /h	1,500	1,750	1,500	3,100	3,200	2,900	
Defrost	Hot gas										
Evaporator	Air flow			m ³ /h	2,300	1,500	2,300		3,450	3,600	
	Air throw (3)			m	10	4			10	4	
Operation range	Cold room Min.~Max.			°C	-5~-10						
Refrigerant	Type/GWP				R-134a/1,430.0		R-290/3	R-134a/1,430.0			R-290/3
	Charge			kg/TCO ₂ Eq	0.86/1.23	-/-	0.82/1.17	0.93/1.33	2.60/3.7	-/-	
Power supply	Phase/Frequency/Voltage			Hz/V	3N~/50/400	1~/50/230	3N~/50/400				

(1) When normally running: -20°C / +30°C

(2) When normally running: 0°C / +30°C

(3) Use air throw as a base. Air throw is affected by many factors such as height of room, product storage, location of evaporator, etc. Contains Fluorinated greenhouse gases

Daikin Europe N.V. · Naamloze Vennootschap · Zandvoordestraat 300 · 8400 Oostende · Belgium · www.daikin.eu · BE 0412 120 336 · RPR Oostende (Responsible Editor)

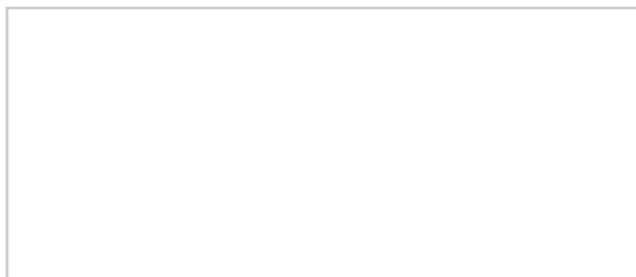

ECPEN19-832A

03/2019

The present publication is drawn up by way of information only and does not constitute an offer binding upon Daikin Europe N.V. Daikin Europe N.V. has compiled the content of this publication to the best of its knowledge. No express or implied warranty is given for the completeness, accuracy, reliability or fitness for particular purpose of its content and the products and services presented therein. Specifications are subject to change without prior notice. Daikin Europe N.V. explicitly rejects any liability for any direct or indirect damage, in the broadest sense, arising from or related to the use and/or interpretation of this publication. All content is copyrighted by Daikin Europe N.V.